



**Dickens Close, Langley, Maidstone, , ME17 1TB**

**Guide Price £260,000**





BEING SOLD THROUGH AUCTION BY CLIVE EMSON. BUYERS TO REGISTER THROUGH CLIVE EMSON [WWW.CLIVEEMSON.CO.UK](http://WWW.CLIVEEMSON.CO.UK) BIDDING OPENS 9TH DECEMBER AND CLOSES 11TH DECEMBER. VIEWINGS MANAGED STRICTLY THROUGH CLIVE EMSON.

**\*\*GUIDE PRICE £260,000 - £270,000\*\*** A spacious and well planned semi-detached bungalow situated on a good sized plot having a frontage of approximately 100'. The property has the benefit of oil fired central heating, UPVC double glazed windows and features a large kitchen and a 26' double glazed conservatory. The popular village of Langley is approximately 6 miles from Maidstone town centre, where all amenities are available. There are a good selection of shops and schools nearby, and the larger village of Headcorn is some 6 miles distance where there is a London line station. No forward chain. Tenure: Freehold. EPC Rating: E. Council Tax Band: D.



## INTERNALLY

**Sitting Room**

**Kitchen/Breakfast Room**

**Large Conservatory**

**Bathroom**

**Bedroom One**

**Bedroom Two**

## EXTERNALLY

The property is situated on a large plot. The front and side gardens are open plan and walled. The wide rear garden is fully enclosed and has a depth of approximately 50'. Oil tank.

**Detached Garage**

## VIEWING

Strictly by arrangement with Clive Emson Auctioneers, please register

<https://www.cliveemson.co.uk/account/#register>

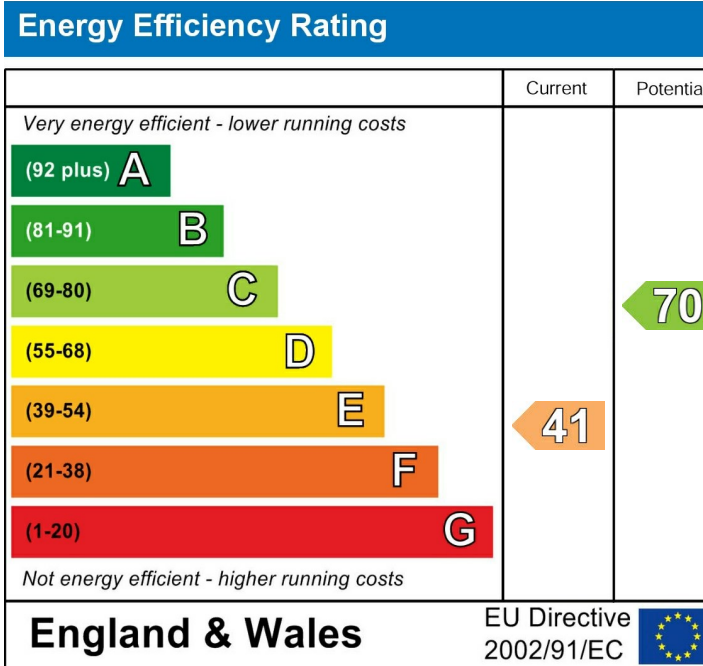



Langley, Maidstone, Kent  
Approximate Gross Internal Area  
909 Sq Ft/84 Sq M

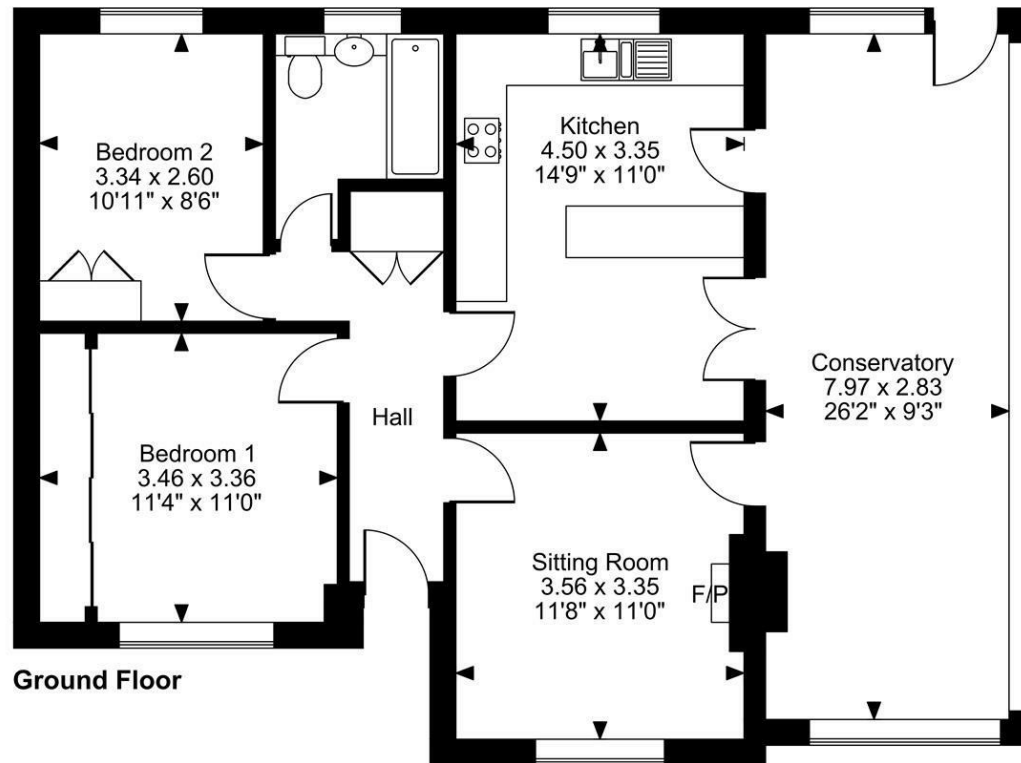
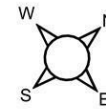

Ground Floor

**FOR ILLUSTRATIVE PURPOSES ONLY - NOT TO SCALE**

The position & size of doors, windows, appliances and other features are approximate only.  
© ehouse. Unauthorised reproduction prohibited. Drawing ref. dig/8627126/TOW

